

# TPLUS 15



CODE	↔	
------	---	--

MA3033	3 m	10'	
MA3034	4 m	12'	
MA3035	5 m	16.4'	

TECHNICAL DATA		
----------------	--	--

	0,65 kg	1,43 lb
<b>V PEAK</b>	113	
	0,6 ÷ 1,0 mm	.023" ÷ .045"
<b>X 60%</b>	180A CO2 - 150A Mix	

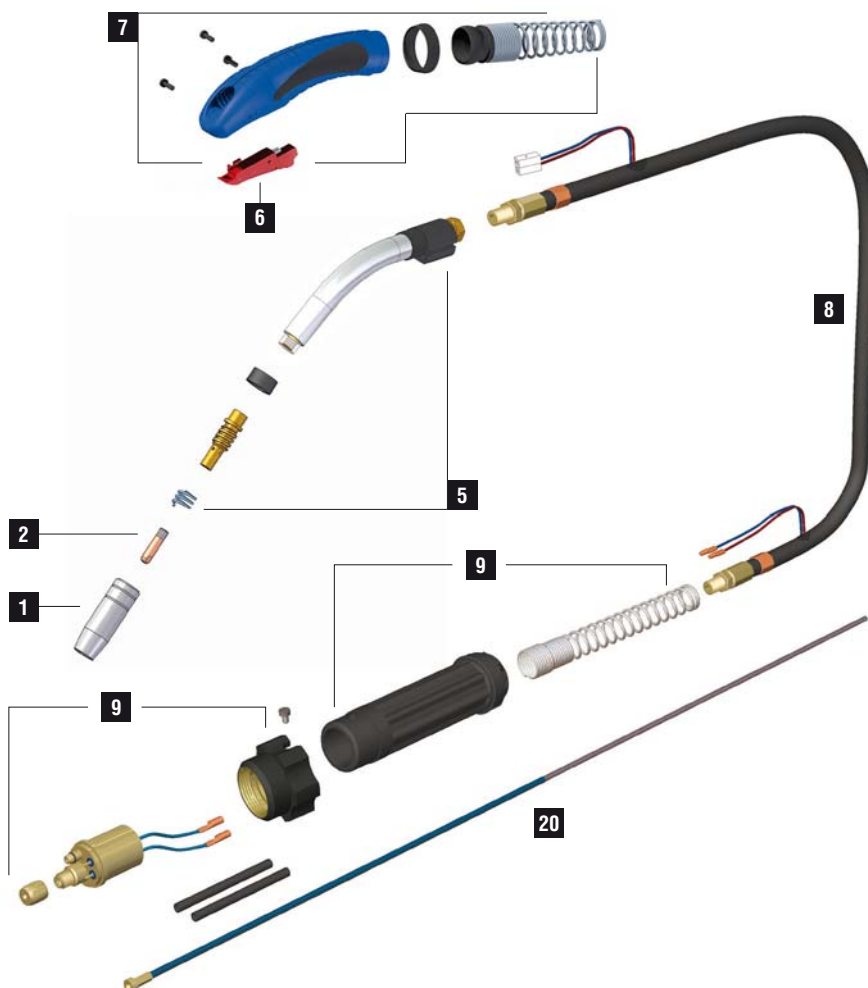

	CODE			Ø		REF		
1	MC0017			9,5 mm	3/8"	53 mm	145.0123 10	
1	MC0018			12 mm		53 mm	145.0075 10	
1	MC0019			16 mm	5/8"	53 mm	145.0041 10	
1	MC0020			16 mm	5/8"	61,5 mm	145.0168 10	
1	MC0266			13 mm	1/2"	53 mm	145.0143 10	
2	MD0008-06		M6 - Cu	0,6 mm	.023"	25 mm	140.0008 20	
2	MD0008-08		M6 - Cu	0,8 mm	.030"	25 mm	140.0059 20	
2	MD0008-09		M6 - Cu	0,9 mm	.035"	25 mm	140.0177 20	
2	MD0008-10		M6 - Cu	1,0 mm	.040"	25 mm	140.0253 20	
2	MD0008-12		M6 - Cu	1,2 mm	.045"	25 mm	140.0387 20	
20	GM0500		blue steel liner	0,6 ÷ 0,9 mm	.023" ÷ .035"	3 m	10'	124.0011 1
20	GM0501		blue steel liner	0,6 ÷ 0,9 mm	.023" ÷ .035"	4 m	12'	124.0012 1
20	GM0502		blue steel liner	0,6 ÷ 0,9 mm	.023" ÷ .035"	5 m	16.4'	124.0015 1

	CODE		
5	MQ0093		1
5	EA0303		10
5	FB0117		
5	MF0380		1
6	BX0742		
7	MT0265		
8	MH0118		3 m - 10' - 16 mm <sup>2</sup>

	CODE		
8	MH0121		4 m - 12' - 16 mm <sup>2</sup>
8	MH0122		5 m - 16.4' - 16 mm <sup>2</sup>
9	AR0070		1
9	BW0020		
9	FA0026		10
9	MT0229		1

STANDARD

FOR ALL CONSUMABLES SEE PAGE 294